

# Raumplan der Schule

## Legende:

- K1, K2 = Kunstraum 1, Kunstraum 2
- KR = Kartenraum      TR = Teilungsraum
- WC = Toiletten      HM = Hausmeister
- SK = Sachkunderaum
- = Treppenaufgang
- PC-R = Computerraum

## 4. Etage

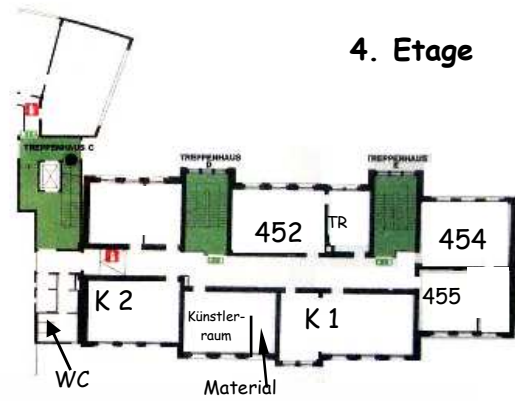

## 3. Etage

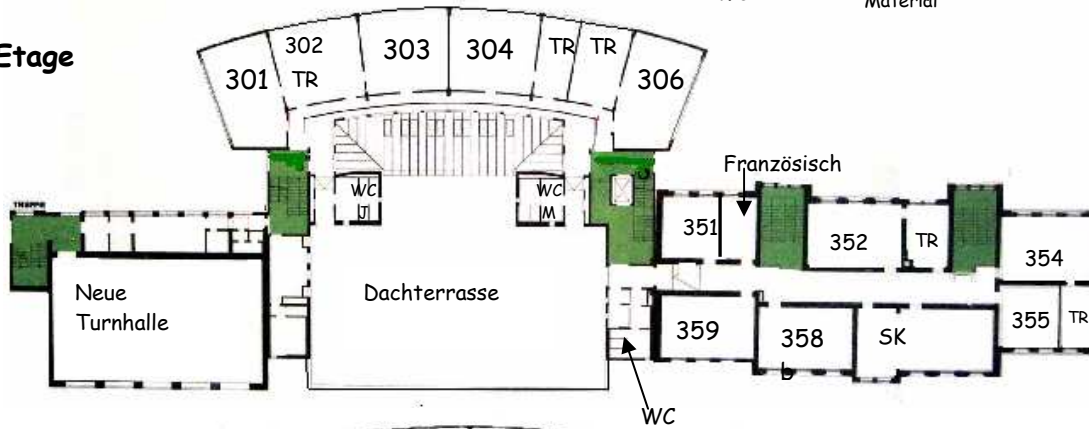

## 2. Etage

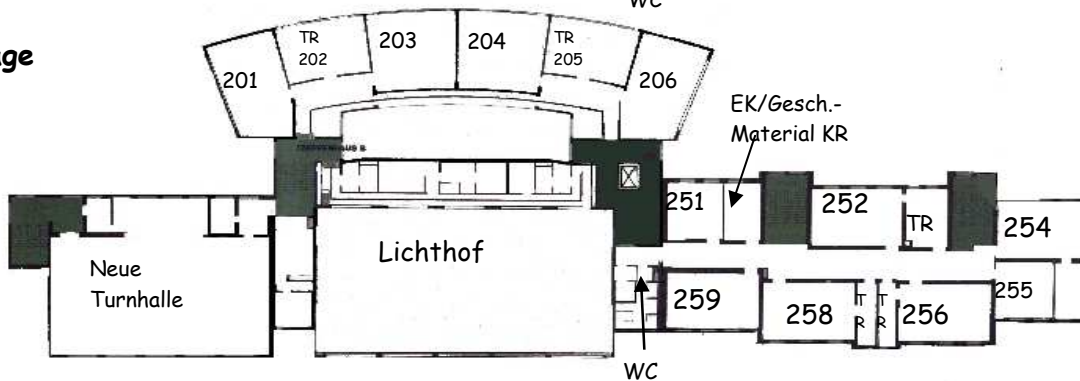

## 1. Etage

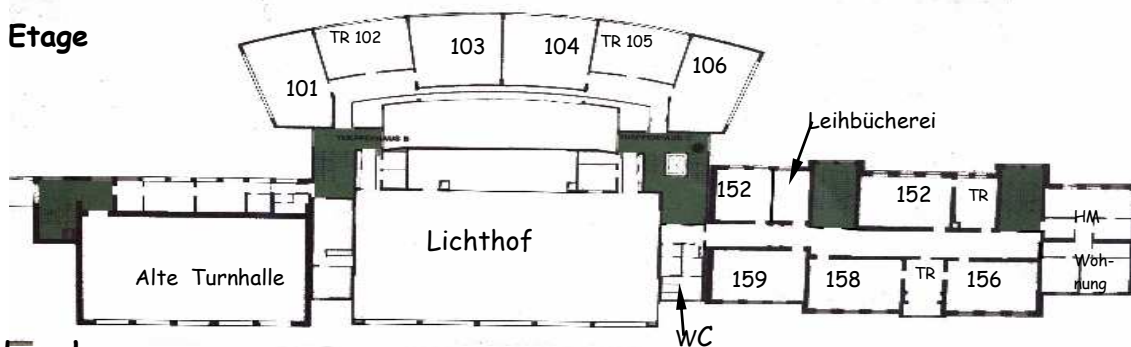

## Erdgeschoss

